



**Verifone®**

*Look for Verifone online help videos on YouTube - search for "Verifone Training Academy."*

## VeriFone Vx680 3G Series Installation Guide

### CHIP CARD PROCESSING: WHAT YOU NEED TO KNOW

This device has the ability to process EMV chip cards. If you are set up to accept chip cards, you will notice a few differences.

1. Chip cards must be inserted into the device or pin pad if attached (swiped transactions are not allowed).
2. The chip card must remain in the device until the transaction is complete.
3. The transaction may require a customer to enter a PIN (similar to a debit transaction).
4. Chip card transactions require the credit card to remain in the the cardholder's possession at all times.

### INSTALLATION INSTRUCTIONS

- Step 1: Open box
- Step 2: Follow installation instructions on page 2
- Step 3: Begin processing

### CONTACT US:

**[www.paymentsinsider.com](http://www.paymentsinsider.com)**  
for user guides and other DIY tips

**1-866-451-4007**  
Activation & Training  
8:30 AM - 9:00 PM ET, M-F

Your  
Payment Solutions  
Team

## CHARGING BASE & POWER CONNECTION

(Place the terminal on the base for charging\*)

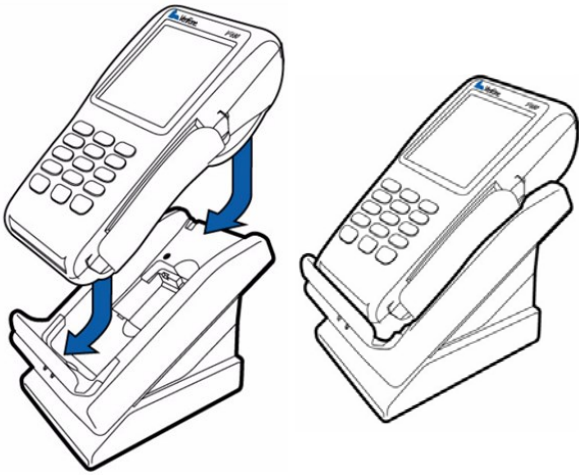

(Connect the power cord to the base and to a power outlet)

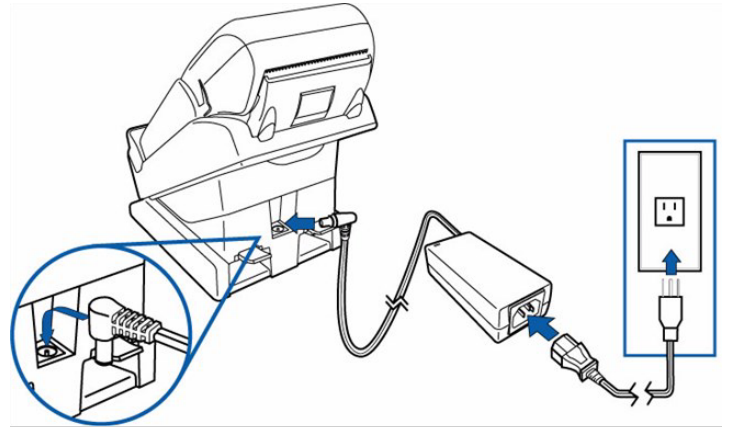

## COMMUNICATION CONNECTION

(For download updates connect to an analog telephone line)

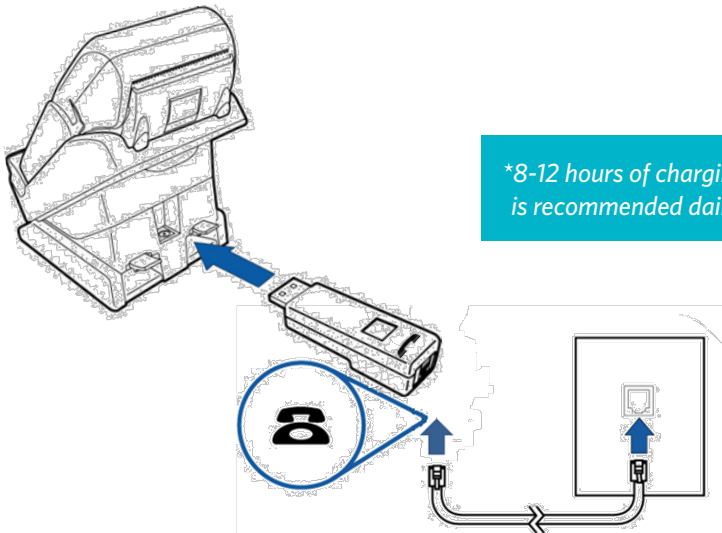

## INSERTING THE PAPER ROLL

(Paper roll must feed as shown with terminal upside down)

